

1201L

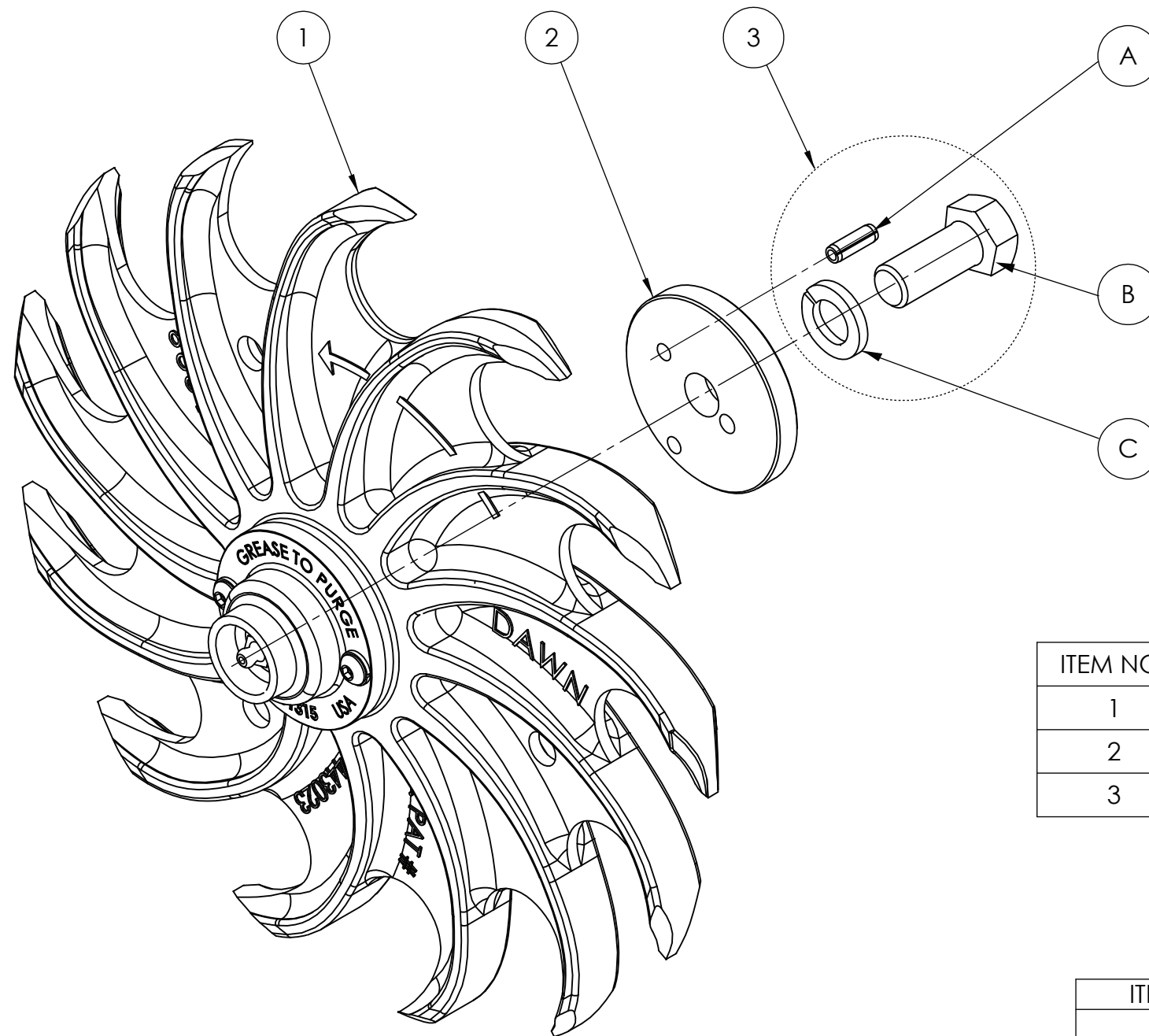

ITEM NO.	PART NUMBER	DESCRIPTION	QTY.
1	400111-LH	CURVETINE ASSY- LH	1
2	101318	SPCR CT1 TPR 3/8" INCL PN	1
3	9882	KIT, CT1 HARDWARE	1

9882 BILL OF MATERIALS

ITEM LETTER	PART NUMBER	DESCRIPTION	QTY.
A	9055	PIN SPRING 1/4 DIA X .75 LG ZN	1
B	9101	HHCS 5/8-11 X 1-1/2 GR8 ZN	1
C	9069	LW 5/8 SPLIT HVY DUTY ZN	1

ITEM NO.	PART NUMBER	DESCRIPTION	QTY.
1	300291	CT 1 PRESS ASSY, LH	1
2	101315_r5	CAP, CT 1 SUPERCAP ROUND	1
3	9880_R1	SCREW BHSCS.SS 1/4-20X5/8	2
4	9662-R1	O-RING, SUPERCAP	1
5	9806	FITNG, GREASE STR 1/8 NPT	1
6	9016	1" TAPERED ROLLER BEARING	2
7	9017	SEAL, TRIPLE LIP, 1.5 DIA	1
8	100066R01	SHAFT, STANDARD HUB	1
9	9024	NUT, 3/4-16 CASTLE	1
10	90010	WASHER, LOCK, 1/4" SS	2
11	9019	PIN, COTTER 5/32X1"	1
12	9785	PLUG, PIPE, 1/8 NPT SS	1
13	9028	WASHER, 3/4 TONGUE	1
14	9803-R1	GROOVED PIN 1/4 X 3/4 ZN	1

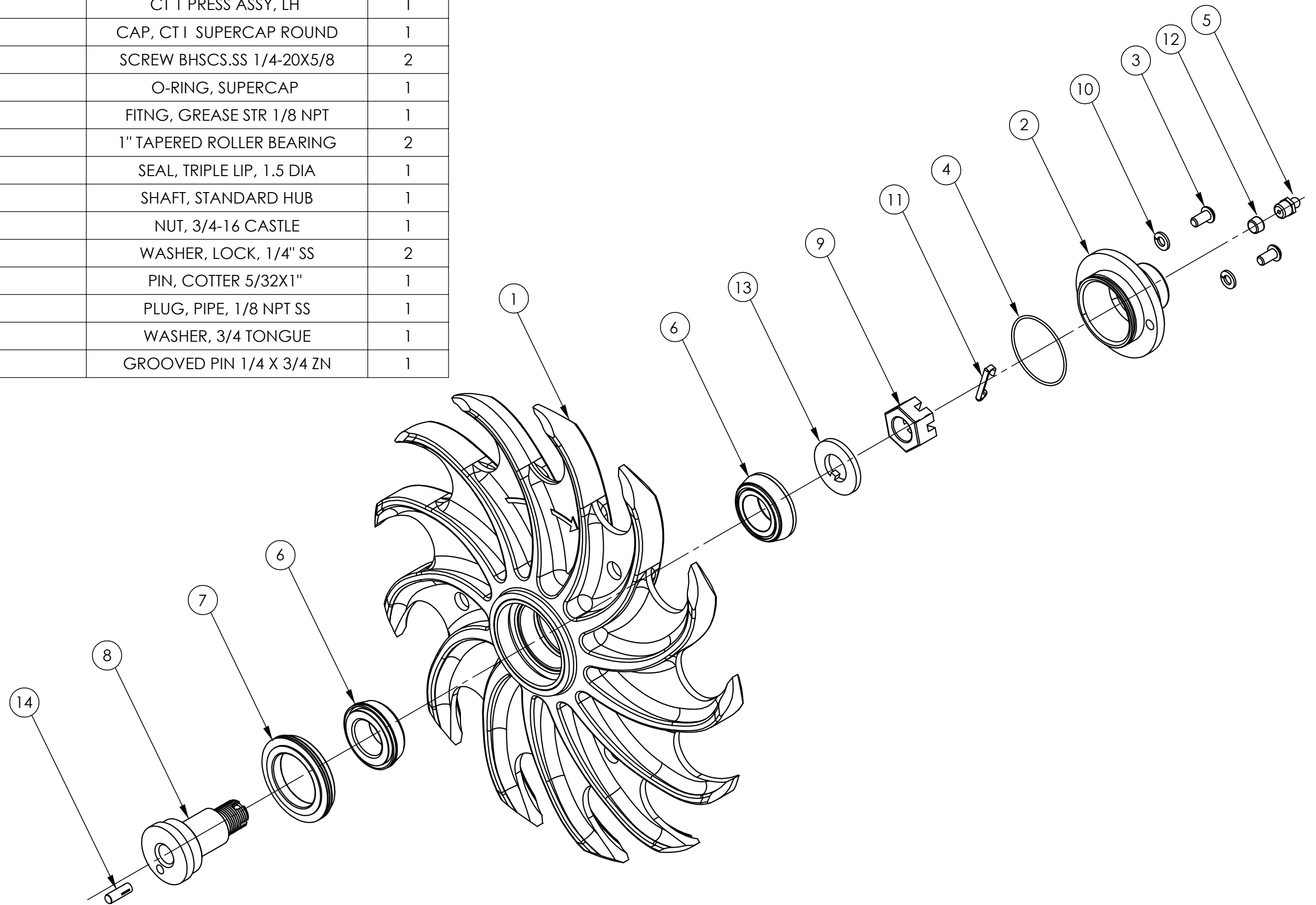

300291

sub-assembly

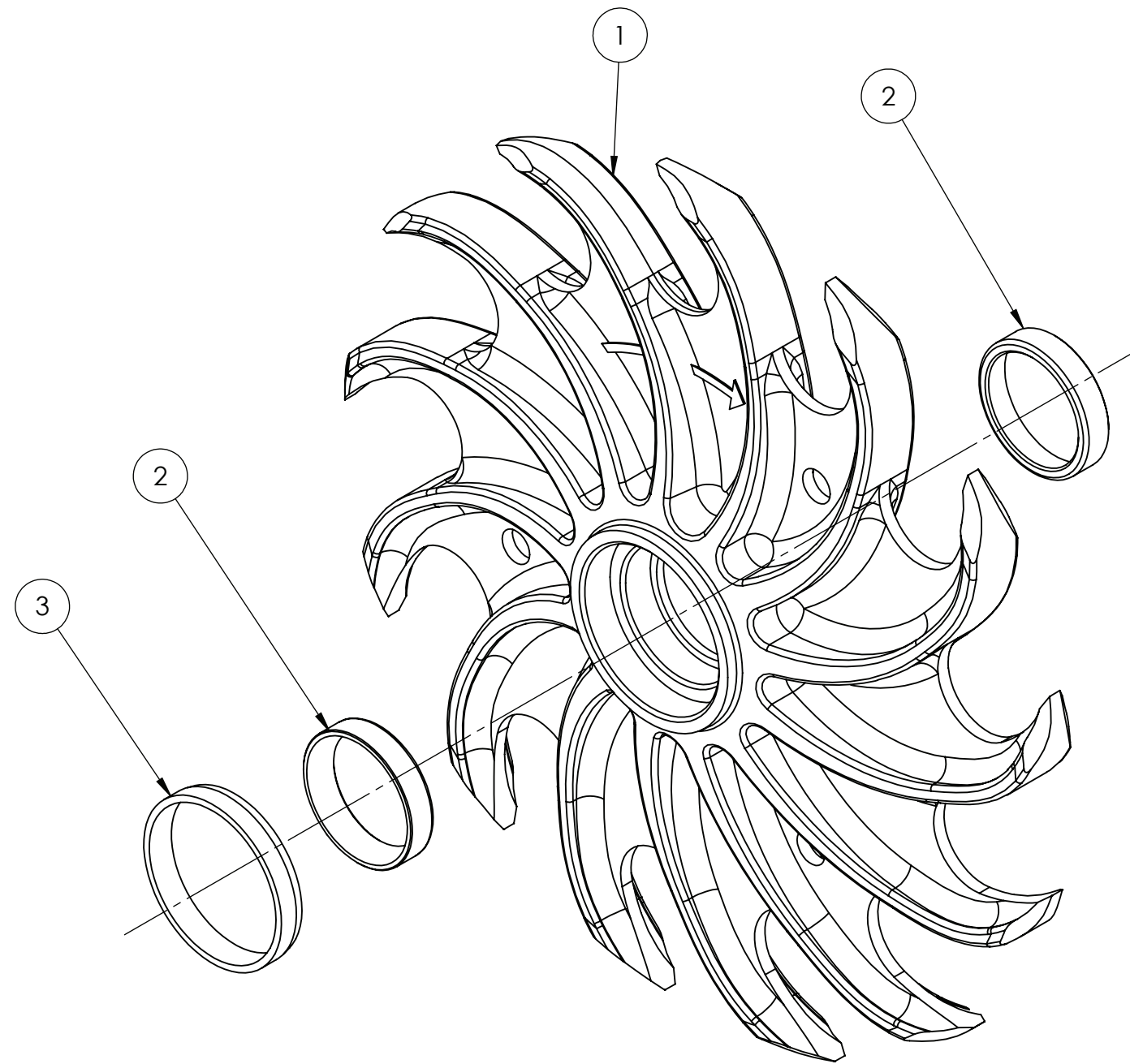

ITEM NO.	PART NUMBER	DESCRIPTION	QTY.
1	101898M_LH	WHEEL, CT3 13" MACH	1
2	9015	BEARING, RACE, 1" SHAFT	2
3	9018	SEAL, RING, PHENOLIC	1